

THIS DRAWING IS UNPUBLISHED. RELEASED FOR PUBLICATION 2005
 © COPYRIGHT 2005 BY - ALL RIGHTS RESERVED.

REVISIONS

P	LTR	DESCRIPTION	DATE	DWN	APVD
F		ADDED PART 1740451-3 AND REVISED	30OCT2012	MZ	ZC
G		REVISED PER ECR-16-002347	22FEB2016	RS	JL
H		ECR-16-003641	11MAY2016	RS	JL
J		ECR-16-017348	24FEB2017	RK	JL

HIGH-VOLTAGE
Keying HV-1

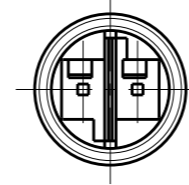

LOW-VOLTAGE
Keying LV-2

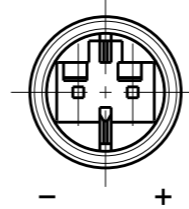

Notes:

1. cavities designed for MQS Pin contact PN 1740335-x
2. Counterpart is Plug PN 1740259-x and corresponding products of the MiniHVL family

- △3 Polarity marking +/- only for DC version (Keying LV-2)
- △4 PN specific marking
- △5 OBSOLETED.

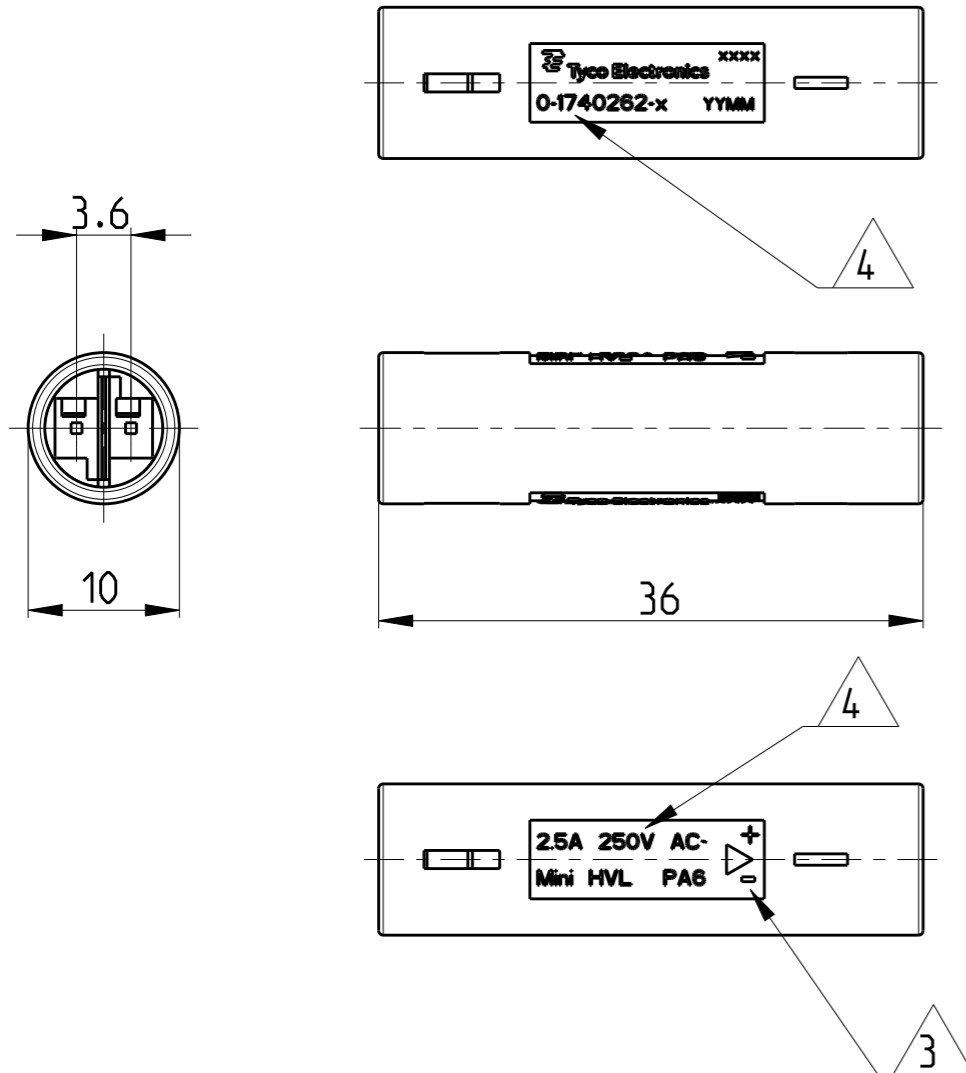

LV-2	LOW-VOLTAGE 125VAC/VDC	7A/125VAC/VDC	BLACK	0-1740451-3
LV-2	LOW-VOLTAGE 125VAC/VDC	7A/125VAC/VDC	YELLOW	0-1740451-2
LV-1	LOW-VOLTAGE 125VAC/VDC	7A/125VAC/VDC	LIGHT GREY	0-1740451-1
HV-3	HIGH-VOLTAGE 125V AC	6A/125V AC ~	BLUE	0-1740262-6
HV-1	HIGH-VOLTAGE 250V AC	2.5A/250V AC ~	BLACK (ANTHRACITE)	0-1740262-2
HV-1	HIGH-VOLTAGE 250V AC	2.5A/250V AC ~	NATURAL (WHITE)	0-1740262-1
Keying	REMARKS	Marking	COLOR	PN

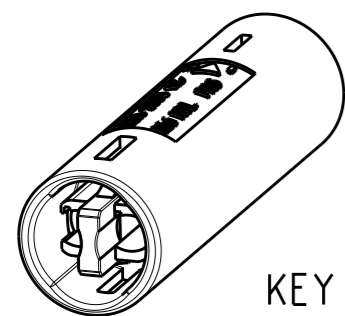

KEYING HV-1
AS SHOWN

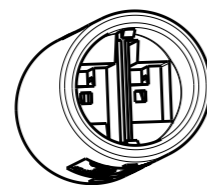

1:1

THIS DRAWING IS A CONTROLLED DOCUMENT.

DIMENSIONS: mm 	TOLERANCES UNLESS OTHERWISE SPECIFIED: 0 PLC ±0.2 1 PLC ±0.2 2 PLC ±0.2 3 PLC ± 4 PLC ± ANGLES ±1°	DWN H.ATZMANN 07FEB2005	TE Connectivity	NAME NECTOR S Connector System Outlet		
		CHK M.OFENLOCH 07FEB2005				
		APVD T.GERLACH 07FEB2005			PRODUCT SPEC 108-94018	SIZE A3
MATERIAL PA 6		FINISH -			APPLICATION SPEC 114-18751	CAGE CODE 00779
		WEIGHT 2.2 g	DRAWING NO C-1740262	RESTRICTED TO -		
CUSTOMER DRAWING			SCALE 2:1	SHEET 1 OF 1		
			REV J			